

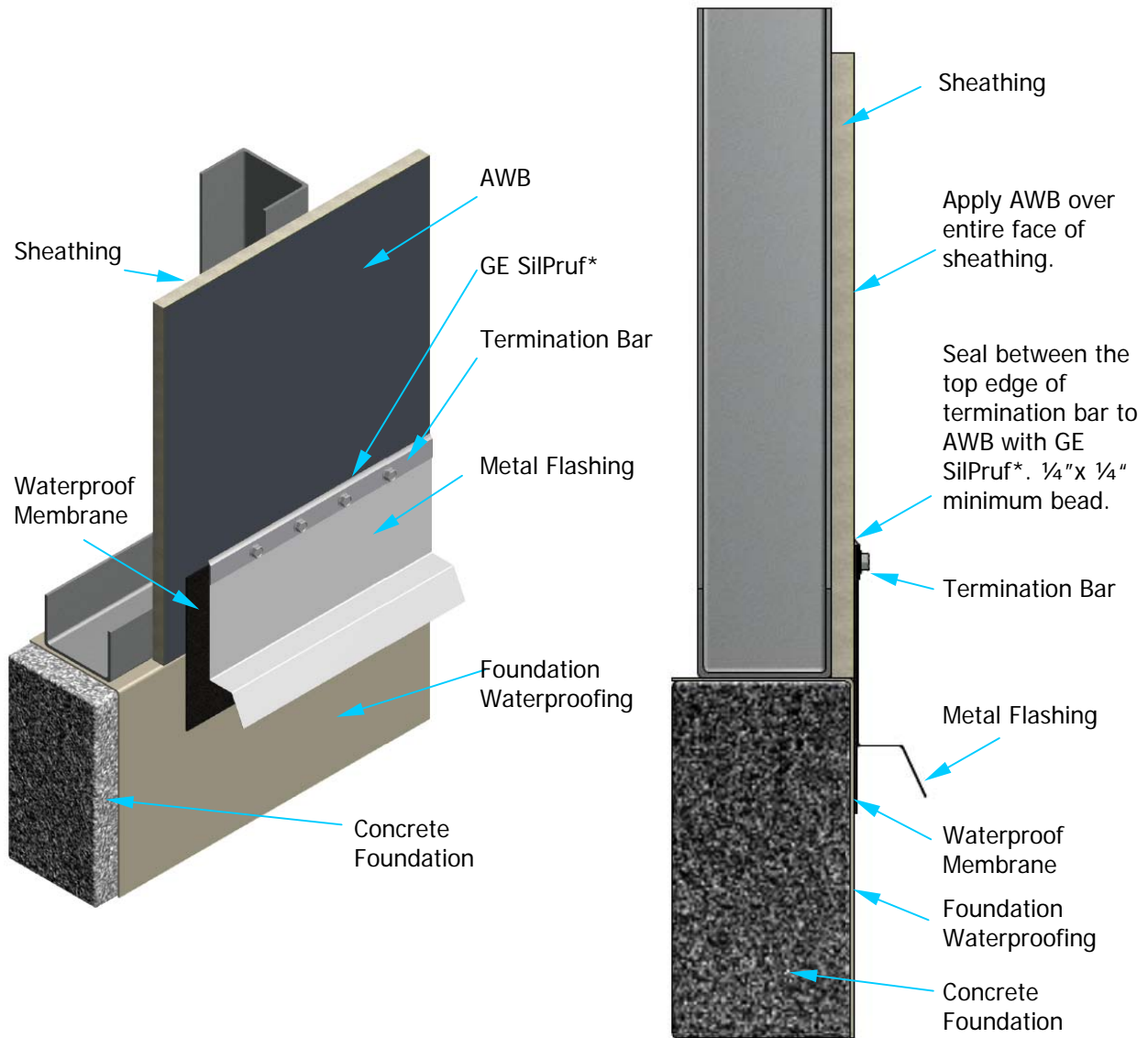

GE Silicone Air Barrier System – Termination at Grade. Sheathing Flush with Foundation



LEGEND	AWB	GE SEC2500 SilShield* AWB Liquid Air and Water Barrier
	UST	GE UltraSpan UST Silicone Transition

This detail is a construction illustration and should be modified as needed for individual project conditions. It is a guideline intended to assist professionals in developing project specific details. Consult appropriate specification documents, data sheets and building codes for specific requirements.



Licensed
Products